

OLFA®

THE ORIGINATOR SINCE 1956

TOP SHEET CUTTER

MODEL:

TS-1



Collecting cuttings from a magazine?

Looking for a better cutting tool for clipping out of a newspaper?



PATENT PENDING

**Incredible as it may seem,
the TS-1 cuts only the top sheet!**

A cutting tool which cuts only the top sheet

MODEL:

TS-1

No underlay necessary; cut freely, off the top of your head!

The TS-1 cuts only the top sheet without being influenced by user's power adjustment. One TS-1 cuts a variety of papers: from a thin piece of newspaper to a thick cover of a magazine.

PATENT PENDING

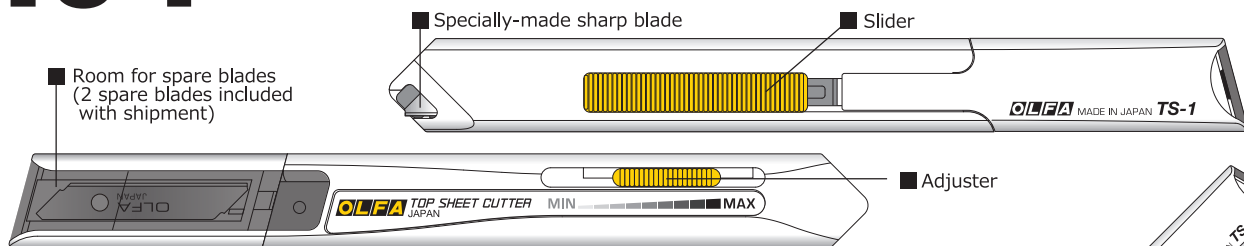

The pressure that hangs to the tip of the blade is kept constant by its built-in spring's working.

Cutting pressure can be controlled continuously by the adjuster on the back of the main body.

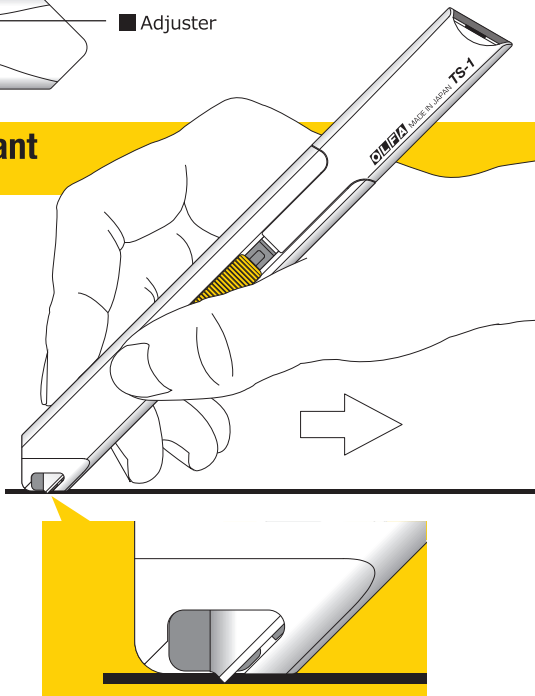
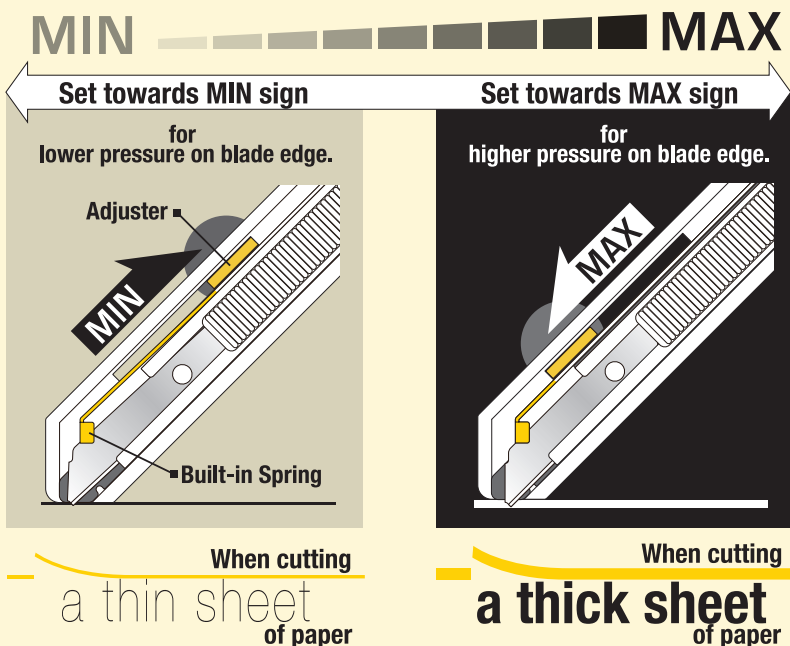

Hold the TS-1 as you hold a pen, and give it enough pressure to leave no space between the TS-1 and a sheet of paper while cutting.

Trial cut is highly recommended while adjusting cutting pressure.

Place an underlay to avoid the possibility of damage to the second sheet, especially when you are never able to damage the sheet of paper below.

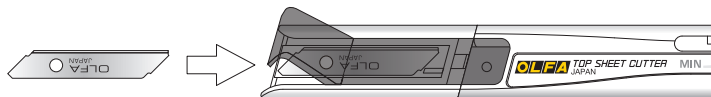
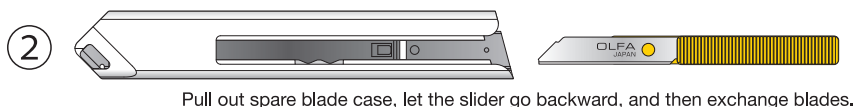
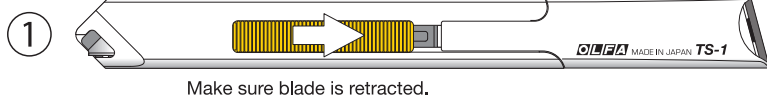

SPARE BLADE

TSB-1

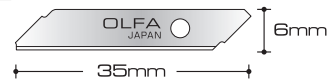

The "TS-1" takes the dedicated blade "TSB-1" only.

Please pay attention to the direction of blades when you store blades in the spare blade case.

MODEL	PACKAGE	BARCODE	INNER BOX	CARTON
TS-1	Blister Packed CARD SIZE: 80 x 220 mm		 200 91511 90012 9	 600 91511 90012 7
TSB-1	Plastic Case in a Plastic bag BAG SIZE: 50 x 167 mm		 200 91511 90019 8	 600 91511 90019 6

! WARNING !

1. OLFA BLADES are extremely sharp! Handle with care.
2. Dispose of used blades in a safe manner.
3. Blade should be retracted while replacing blades and when not in use.
4. Keep out of the reach of children.

URL <http://www.olfa.com>

MANUFACTURED BY OLFA CORPORATION, OSAKA 537-0021, JAPAN

OLFA
THE ORIGINATOR SINCE 1956